

This drawing is copyright and is not to be reproduced. The contractor will be held responsible for the accuracy of works involving the setting out and checking of all dimensions on the drawing and on site. Dimensions must not be scaled from this drawing.

**PLANNING ISSUE**

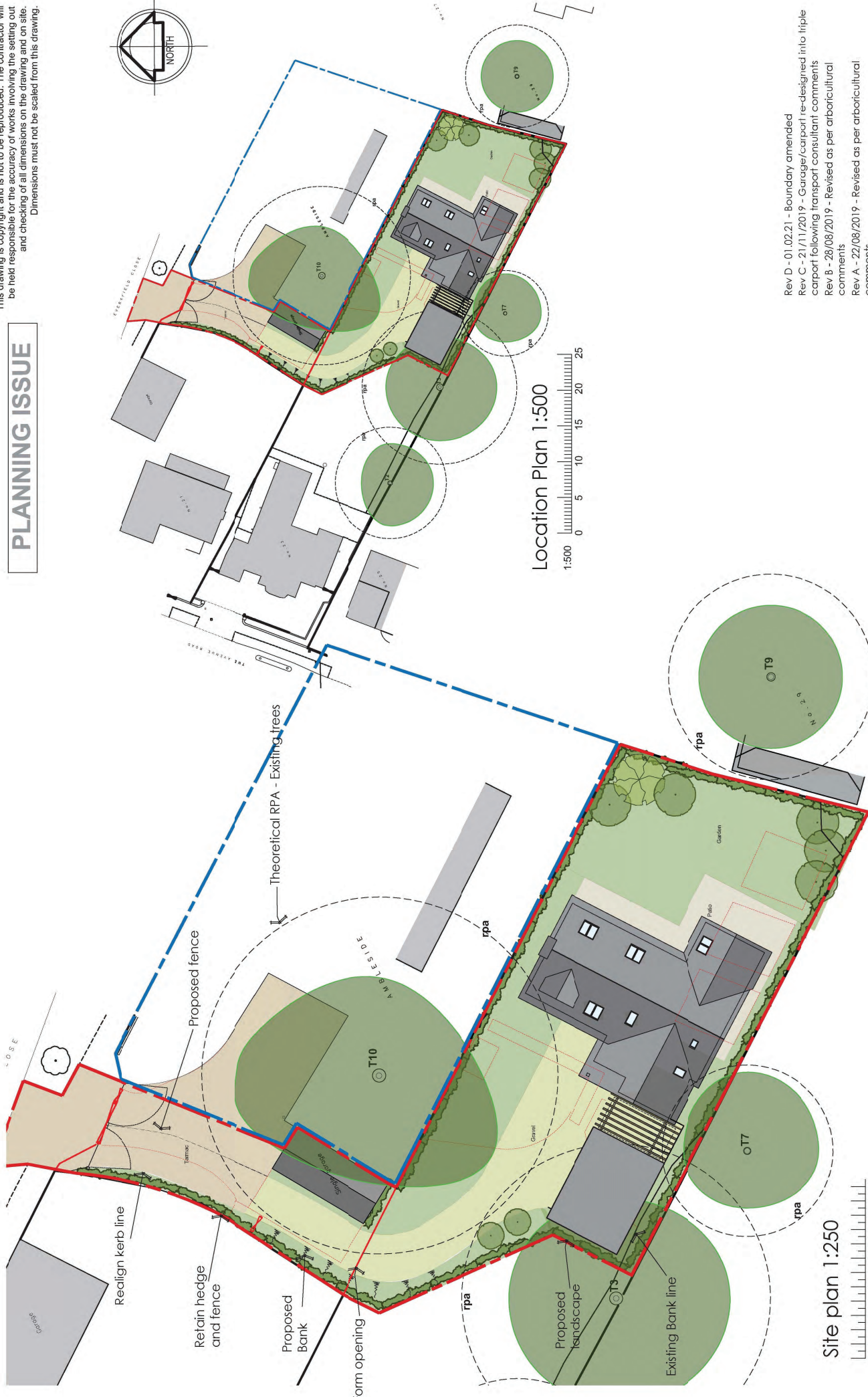

**23 The Avenue, Andover**

Rev D - 01/02/21 - Boundary amended  
 Rev C - 21/11/2019 - Garage/carport re-designed into triple carport following transport consultant comments  
 Rev B - 28/08/2019 - Revised as per arboricultural comments  
 Rev A - 22/08/2019 - Revised as per arboricultural comments  
 REVISIONS:

SCALE: 1:250 & 1:500 @ A3  
 DATE: Aug 2019  
 DRAWING No. P19-030  
 CHECKED BY: PA  
 DRAWN BY: CM  
 02-02-002D

DRAWING TITLE:  
 Proposed site plan

PROJECT: Proposed redevelopment of 23 The Avenue, Andover,  
 SP10 3EW  
 CLIENT: Mr & Mrs Brown

**barclay+phillips**  
 architects

The Studio, E Colindale Office Park,  
 Southampton Road, Salisbury SP5 3HT  
 enquiries@barclay-phillips.co.uk  
 t: +44 (0) 1722 711177  
 www.barclay-phillips.co.uk